



buschfeld.com

## GUIDED TOURS AND CONTACT

### Opening Hours and Entrance

Field of Stelae – 24 hours a day; Information Centre –  
Apr. - Sep.: Tue - Sun 10 a.m. - 8 p.m. (last admission: 7:15 p.m.)  
Oct. - Mar.: Tue - Sun 10 a.m. - 7 p.m. (last admission: 6:15 p.m.)  
Closed on 1 Jan., 24 to 26 Dec. and 31 Dec.;  
Field of Stelae and Information Centre: admission free

### Public Transport

Bus: 100, 123, 148, 200, M 41, TXL  
S-Bahn: Unter den Linden and Potsdamer Platz, S 1, S 2, S 26  
U-Bahn: Potsdamer Platz and Mohrenstraße, U 2

### Information and Booking

Tel. +49 - (0)30 - 26 39 43 36 (Mon - Thu 10.00 a.m. - 4.00 p.m.,  
Fri 10.00 a.m - 1.00 p.m.); Fax: +49 - (0)30 - 26 39 43 21  
E-Mail: [besucherservice@stiftung-denkmal.de](mailto:besucherservice@stiftung-denkmal.de)

### Audio Tour

fee: 3,00 Euro (1,50 Euro reduced)  
available at the Information Centre

### Guided Public Tours

Sat / Sun: 11.00 a.m. / 2.00 p.m. (German); Sun: 4.00 p.m.  
(English); meeting point: elevator building at the  
corner of Cora-Berliner- and Hannah-Arendt-Straße;  
max. number of participants: 25 persons; fee: 3,00 Euro  
(1,50 Euro reduced) per participant

### Contact

Memorial to the Murdered Jews of Europe  
Cora-Berliner-Straße 1, 10117 Berlin, Germany  
[www.stiftung-denkmal.de](http://www.stiftung-denkmal.de)





## **CHRONOLOGY**

### **1988/89**

Publicist Lea Rosh calls for a »high-profile memorial«, winning support from Willy Brandt, Günter Grass and Christa Wolf, among others

### **1994/95**

Public artistic competition held for the memorial, which ended without a result

### **Summer 1997**

Following public colloquiums, a new memorial competition is launched among invited artists/architects

### **Spring 1998**

Vote by Federal Chancellor Kohl for the design by Eisenman/Serra, but decision delayed by Federal elections

### **25 June 1999**

Resolution passed by the German Bundestag to build the memorial and establish a Foundation

### **1 April 2003**

Construction work begins

### **12 July 2004**

Topping-out ceremony at the Information Centre

### **15 December 2004**

Last stele erected

### **12 May 2005**

Public inauguration



## **FIGURES ON THE MEMORIAL**

### **Field of Stelae**

**Size of the Field of Stelae:** 19,073 m<sup>2</sup>

### **Number and dimensions of the stelae**

2,711 stelae made of high-quality concrete, each measuring 0.95 m in width and 2.38 m in length, hollow, with inclinations of between 0.5° and 2°

of which

303 stelae are more than 4 m high

569 stelae are between 3 and 4 m high

491 stelae are between 2 and 3 m high

869 stelae are between 1 and 2 m high

367 stelae are between 0 and 1 m high

112 are flat stelae slabs

Weight of the largest, 4.7 m-high stelae: approx. 16 t

Average weight of a stelae: approx. 8 t

**Paved area:** 13,100 m<sup>2</sup>; with 13 special routes for disabled people; there are 41 trees on the Field of Stelae

### **Area of Information Centre**

Exhibition rooms: 778 m<sup>2</sup>

Seminar rooms: 106 m<sup>2</sup>

Bookshop: 46 m<sup>2</sup>



## FAQS

### **Why is the memorial dedicated only to the murdered Jews?**

After a long debate, the German Bundestag decided in 1999 to dedicate the memorial to the murdered Jews of Europe. This underlines that acknowledging the uniqueness of this crime and historic responsibility is central to the Federal Republic of Germany's self-understanding. The Foundation has the task of ensuring that all victims of National Socialism are remembered and honoured appropriately. This also involves building memorials to the Sinti and Roma and to homosexual victims, which has already been decided upon by the Federal Government.

**Why was the memorial built in this location?** — The location at the heart of Berlin and in the vicinity of embassies, cultural institutions, business and residential premises, as well as the Tiergarten, expresses the memorial's public character. Its integration into the historic urban space and the parliament and government district highlights the fact that the memorial is directed towards the civil society.

### **Why are there 2,711 stelae and what are they made of?**

The total number of 2,711 stelae results from the measurements chosen by the architect for the location. It does not have any symbolic significance or relationship to the number of victims. The stelae were produced near Berlin from very hard, grey-coloured, self-compacting concrete. In order to guarantee the high quality of the stelae surface for as long as possible, the stelae were treated in a multi-stage protection process, which also enables graffiti to be easily removed.



Stiftung Denkmal

**Are there World War II bunkers underneath the memorial?**

The bunker of Goebbels' office villa is located in the north-eastern corner of the memorial site; it was unchanged by the construction of the memorial. The »Führerbunker« was 200 to 300 m south of the memorial site near Vossstrasse.

**How much did the memorial cost?** — Euro 27.6 million from Federal budget funds were spent on building the memorial (Euro 14.8 million on the Field of Stelae and Euro 12.8 million on the Information Centre).

**What part do Lea Rosh and the Association Memorial to the Murdered Jews of Europe play in relation to the memorial?**

The publicist Lea Rosh and the Association Memorial to the Murdered Jews of Europe that has been set up prompted the construction of the memorial in 1988/89 and since then have done a great deal to support the project. The Association has a number of representatives on the Board of Trustees of the Foundation, which is chaired by the President of the German Bundestag, Dr. Norbert Lammert. The donations collected by the Association are to be used to extend the collection of names in the Information Centre.

**What is the purpose of the donations in the Information Centre?** —

The donations are particularly used for the preservation and extension of the exhibition in the Information Centre. Also, scientific projects which stand in close connection with the documentation in the Information Centre are supported financially thereby. We are deeply grateful for donations to the following account: Berliner Sparkasse; Bank code number: 100 500 00; Account number: 6600 0076 62; BIC: BELADEVXXX, IBAN: DE24 1005 0000 6600 0076 62

**INFORMATION**  
THE MEMORIAL  
TO THE MURDERED  
JEWS OF EUROPE





Stefan Müller

## **ARCHITECTURE AND ARCHITECT**

The memorial is located near the Brandenburg Gate. It was built between 2003 and 2005 according to a design by the architect Peter Eisenman. This design represents a radical approach to the traditional concept of a memorial, partly because he does not use any symbolism. The grid pattern, consisting of 2,711 concrete stelae, which can be walked through from all sides, leaves it up to visitors to find their own way in and out of the complex. The underground Information Centre which is located in the south-eastern corner of the Field of Stelae is accessible via stairs and a lift. Designed by Dagmar von Wilcken, it takes up its formal language and provides information on the victims, the places of extermination and today's memorial sites.

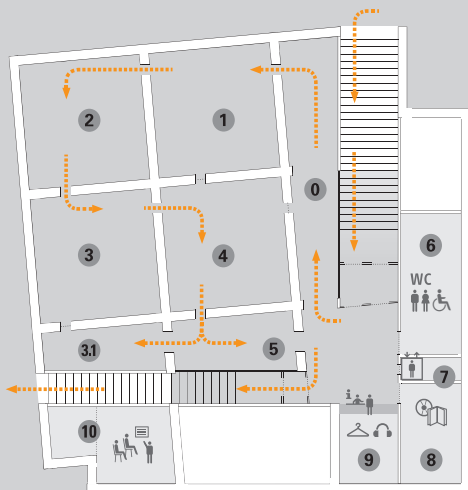

Dagmar von Wilcken / buschfeld.com

## INFORMATION CENTRE

- 0 Introduction
- 1 Room of Dimensions
- 2 Room of Families
- 3 Room of Names
- 3.1 Pages of Testimony from Yad Vashem
- 4 Room of Places
- 5 The Holocaust memorials.database
- 6 Toilets
- 7 Lift
- 8 Bookshop/DVD and Catalogue\*
- 9 Information/Cloakroom/Audio Tour\*\*
- 10 Seminar Rooms

### \* DVD and Catalogue

In our bookshop you can acquire the catalogue and the DVD about the memorial. In addition to the contents of the exhibition both publications offer extensive further materials.

### \*\* Audio Tour

The Audio Tour from Antenna Audio, lasting one hour, leads through the exhibition in the Information Centre. Among other things, the tour provides the historical background and destinies of the victims, on the basis of quotations, contemporary witness's voices and historian's contributions. The Audio Tour is available in German and English. You can obtain the equipment in the entrance area.



Gunter Lepkowski

## **INTRODUCTION 0**

A tour through the Information Centre starts by surveying the Nazis' extermination policy between 1933 and 1945. A series of texts and pictures shows the development that led to the Holocaust and the process of the extermination of the European Jewry, as well as the persecution and murder of other victims groups.

## **ROOM OF DIMENSIONS 1**

Fifteen personal accounts written down by Jewish men and women during the persecution are the focus of this subject room. This individual level is supplemented by a tape stating the numbers of victims in the occupied European countries. The countries relate to their 1937 borders.



Gunter Lepkowski

## ROOM OF FAMILIES 2

Different social, national and religious Jewish milieus are shown in this room, based on the fates of fifteen Jewish families. The stories of these Jewish families reflect the diversity of European Jewish culture and tradition before the Holocaust. The stories also highlight the transformation undergone by the European Jews since the rise of religious and political reform movements in the nineteenth century. This documents the contrast between life before, during and after the Nazi persecution, the destruction of this culture and the loss it brought in its wake. Photographs and personal documents report on the dissolution, expulsion and extermination of these families and their members.





Gunter Lepkowski

## **ROOM OF SITES** 4

This room documents the geographic spread of the genocide of the Jews across Europe. 220 sites are presented as examples of sites where European Jews were persecuted and exterminated using historical film and photographic material. They include sites of mass executions, extermination and concentration camps, ghettos, deportation routes and death marches.

## **THE HOLOCAUST MEMORIALS.DATABASE** 5

The tour ends at the Holocaust memorials.database. There are computer terminals here providing information on current events at historical sites and on research institutions throughout Europe. There is another terminal in the lobby's exit area documenting the debates on the Memorial to the Murdered Jews of Europe.